

USER INSTRUCTIONS

Mezzalad



CONTENTS:

[Declaration of Conformity](#)

[Compliance](#)

[Model Numbers and date/s of Manufacture](#)

[Design Purpose and Safe Operation](#)

[Assembly](#)

[Inspection and Initial Testing](#)

[Maintenance and Routine Inspection](#)

[Weights, Dimensions and Size Selection](#)

[General Instructions](#)

[Labeling and Safety Notifications](#)

Declaration of Conformity

The Manufacturer:

CUSTOM LADDER COMPANY PTY LTD
29 Lorn Road
QUEANBEYAN NSW 2620
AUSTRALIA

Declare that the Products:

STOCKMASTER MEZZALAD

SM-CM100, SM-CM101, SM-CM102, SM-CM103, SM-CM104,
SM-CM105, SM-CM106, SM-VH01, SM-VH02, SM-VH03, SM-VH04
SM-CM111, SM-CM112, SM-CM113, SM-CM114

This product has been designed and manufactured in accordance with the relevant provisions of the following standards:

- AS 1892.1:2018 – Industrial classification
- EN 131:2018 – Professional use classification

It meets or exceeds the performance requirements of:

- AS 1892.1:2018 – Industrial
- EN 131:2018 – Professional use
- ANSI A14.2-2017 – Type IA (Extra Heavy Duty)

This declaration of conformity is issued under the exclusive responsibility of the manufacturer



G. M. BOWER
MANAGING DIRECTOR
FEBRUARY 21 2020

GO BACK <<<

GO BACK <<<

Compliance

Stockmaster Mezzanine Access Ladders comply with the relevant elements of standards

- AS 1892.1:2018
- EN 131.7::2018

Stockmaster Mezzanine Access Ladders exceed the performance requirements of standards

- AS 1892.1:2018 - "HIGHER STABILITY", "INDUSTRIAL"
- EN 131.7 - "OUTDOOR USE", "INDUSTRIAL"
- ANSI A14.2:2017 - "EXTRA HEAVY DUTY"

Stockmaster Ladders are Designed and Manufactured by:

CUSTOM LADDER COMPANY PTY LTD
29 LORN RD QUEANBEYAN N.S.W.
AUSTRALIA

Stockmaster Ladders are Distributed throughout the European Community by:

EUROKLIM BV
LINDELAUFER GEWANDE 30C
NL 6367 AZ VOERENDAAL
THE NETHERLANDS

Model Numbers and date/s of Manufacture

This Information can be found on the label fixed to the inside of the side rail of the ladder

GO BACK

Design Purpose and Safe Operation

Stockmaster Mezzalad

This product has been designed to provide floor to floor access where it is positioned on a set of locating brackets which are fastened to the floor or wall of the building. Examples are mezzanine floors, loading docks and similar situations. Additionally, with sets of locating brackets installed at multiple positions, the ladder may be relocated from position to position. When relocating the ladder to a new position, care must be taken to ENSURE THE LADDER IS CORRECTLY ENGAGED WITH THE LOCATING BRACKETS BEFORE USE. In situations where no wall exists between floor levels, a locating device is also required at the lower floor level. A Safety Gate is provided at the upper floor level to maintain the integrity of the perimeter railing.

Operating the ladder

- To open the Ladder stand in front of it, take hold of the handrails and raise it up so that the feet just clear the floor. Pull the Ladder fully towards you whilst walking backwards and allow the feet to take up a position on the floor. Ensure the Ladder is fully open before use.
- To close the ladder stand in front of it, take hold of the handrails and raise it up so that the feet just clear the floor. Push the ladder fully to the wall or floor mounted location and allow the feet to take up a position on the floor.
- Using the Safety Gate. To open the gate, raise it up to the vertical position and allow it to drop in to the locked open position. To close the gate, pull up on the bar and lower into the locating bracket. The gate must remain closed at all times when persons are present on the upper floor.

Assembly

General Assembly:

Instructions for assembly are provided in graphic form. These must be followed to ensure correct assembly and safe working of the product. They also provide the most simple method for assembly. If you are unsure of any of the instructions, please consult your dealer.

Note: Any defect arising as a result of incorrect assembly will not be covered under your product warranty.

GO BACK

Inspection and Initial Testing

On completion of the assembly and BEFORE USING, do the following

- Check that all fastenings have been tightened.
- Check that the locating brackets are firmly fixed to the building structure.
- Pull the MEZZALAD out to the use position. Check that both Ladder feet are in ground contact and that the angle of incline of the Ladder to the ground is not more than 70 degrees (steps parallel to ground) and not less than 60 degrees (steps with slight 10 degree tilt forward).
- Push the MEZZALAD back to the store position and check that it remains captive by the locating brackets.

Maintenance and Routine Inspection

When Assembled correctly, little maintenance is required. It is however advisable to regularly inspection the unit to maintain safe operation. The following items should be taken into account.

- Check that the stiles/legs (uprights) are not bent, bowed, twisted, dented, cracked or corroded;
- Check that the stiles/legs around the fixing points for other components are in good condition;
- Check that fixings (usually rivets, screws or bolts) are not missing, loose, or corroded;
- Check that rungs/steps are not missing, loose, excessively worn, corroded or damaged;
- Check that the guide brackets are not missing, damaged, loose or corroded and engage properly on the mating stile;
- Check that ladder feet / end caps are not missing, loose, excessively worn, corroded or damaged;
- Check that the entire ladder is free from contaminants (e.g. dirt, mud, paint, oil or grease);

If any of the above checks cannot be fully satisfied, DO NOT USE the ladder.

Weights, Dimensions and Size Selection

VH Series			CM Series					
			Available in Australia only					
MODEL	SERVICE HEIGHT	WEIGHT	MODEL	SERVICE HEIGHT	WEIGHT	MODEL	SERVICE HEIGHT	WEIGHT
VH01	2.330m - 2.529m	19.3 Kg	CM101	1.310m - 1.420m	13 Kg	CM106	1.975M - 2.145m	17.7 Kg
VH02	2.529m - 2.744m	20.2 Kg	CM102	1.420m - 1.545m	13.7 Kg	CM111	3.225m - 3.385m	24.5 Kg
VH03	2.744m - 2.977m	22.7 Kg	CM103	1.545m - 1.675m	13.9 Kg	CM112	3.385m - 3.675m	25.6 Kg
VH04	2.977m - 3.225m	23.6 Kg	CM104	1.675m - 1.820m	14.7 Kg	CM113	3.675m - 3.990m	26.7 Kg
			CM105	1.820m - 1.975m	16.8 Kg	CM114	3.990m - 4.280m	29.7 Kg

GO BACK

General Instructions all Models

- Inspect the Ladder after delivery. Before every use visually check the Ladder is not damaged and is safe to use. Do not use a damaged Ladder.
- Do not exceed the Maximum rated load
- Ensure the ground or floor surface is firm and acceptably level before use
- Do not overreach - Keep your centre of gravity within the platform area
- Ensure the ground or floor surface is free form oils or spills - Do not use on contaminated ground
- Maximum number of users is limited to 1 at any given time
- Face the Ladder when ascending and descending - Do not ascend or descend with your back to the steps
- Keep a secure grip on the Ladder when ascending or descending. Maintain a handhold whilst working from a ladder or take additional safety precautions if you cannot
- Avoid work that imposes a sideways load on Ladders, such as side on drilling through solid materials
- Do not carry equipment which is heavy or difficult to handle while using a Ladder
- Do not wear unsuitable footwear - Wear slip resistant footwear
- Do not use the Ladder if you are not fit enough. Certain medical conditions or medication, alcohol or drug abuse could make Ladder use unsafe
- Do not spend long periods on a Ladder without regular breaks - Tiredness is a risk
- Prevent damage of the Ladder when transporting by fastening and ensuring the Ladder is suitably positioned
- Ensure the model of Mezzalad has been chosen to suit the service height
- Do not use the Ladder if contaminated - Keep Ladder treads and platform clean and free from grease and oils
- Do not use outside in adverse conditions such as strong winds and heavy rain
- A risk assessment must be carried out prior to use respecting the legislation in the country of use
- When positioning the Ladder for use. Take into account the risk of collision with the Ladder - Do not place the Ladder where the risk of collision with vehicles, pedestrians or doors may occur.
- Do not use where Electrical hazard exists - Identify any electrical risks such as overhead power-lines or other exposed electrical equipment.
- Use Non-conductive ladders for unavoidable live electrical work
- Do not use the Ladder as a bridge
- Do not modify the Ladder design
- Do not step off the side of the ladder onto another surface or structure

Labeling and Safety Notifications

Stockmaster Mezzanine Access Ladders are 150Kg Professional / Industrial rated. The maximum load includes the weight of the user and all other items including tools, equipment or goods being handled

Stockmaster Mezzanine Access Ladders have been labeled in accordance with AS1892.1, EN131 . It is mandatory that operators familiarise themselves with all safety notifications relating to the safe use and operation of this product in order to avoid accidents. Numerous safety symbols appear on the product labels for advice on safe use and operation - DO NOT REMOVE THESE LABELS.

GO BACK

User Instructions

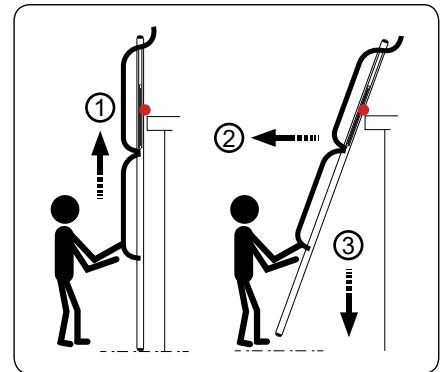
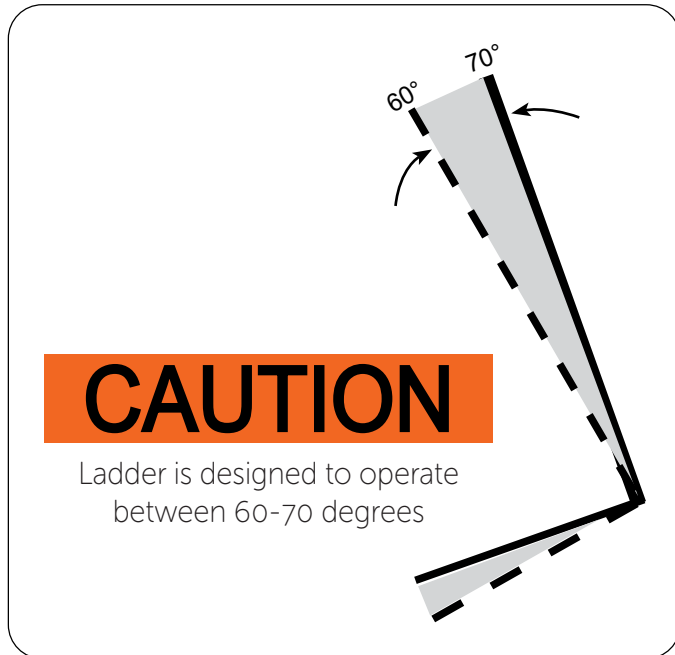

Raise, Pull out, Lower the Ladder



Maximum Total Load



Maximum Number of Users



Misuse may result in serious injury, paralysis



Keep secure Grip

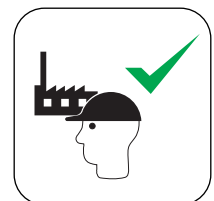

Industrial / Professional Use



Warning, Fall from the Ladder



Refer to Instruction Manual



Do not Overreach



Visually Inspect the Ladder for Damage prior to use

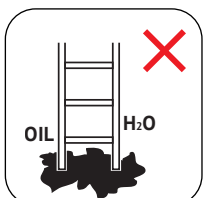

Do not use on Contaminated Ground

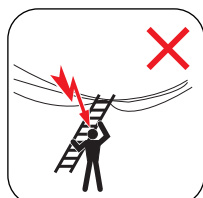

Do not use where Electrical hazard



Do not Ascend or Descend With your back to the steps

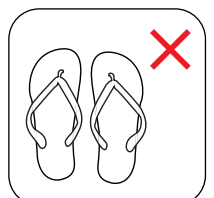

Do not wear Unsuitable Footware

GO BACK